

In the Box

Setup

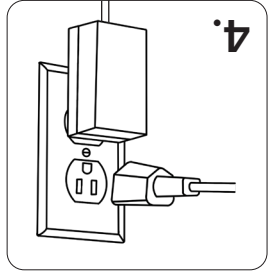

Always use a drip loop. Water damage is not covered under warranty.

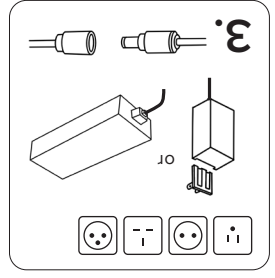
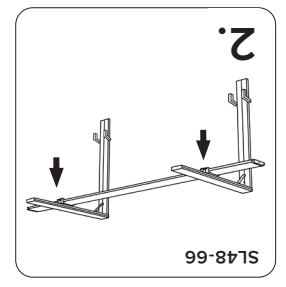
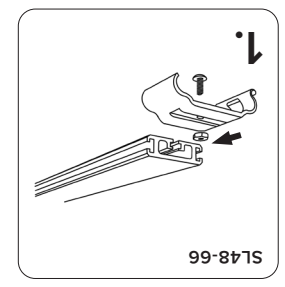
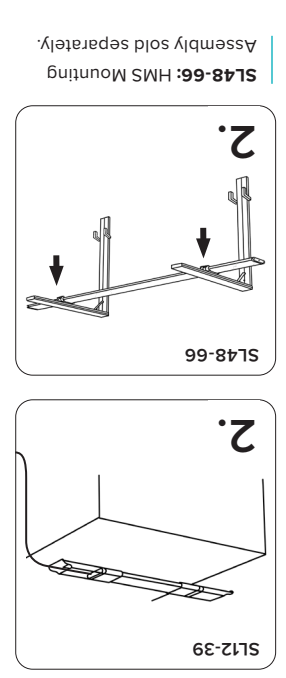
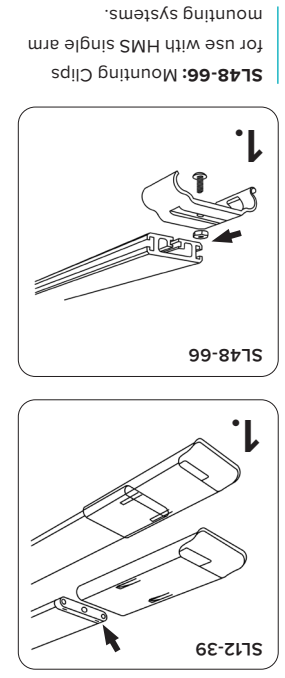
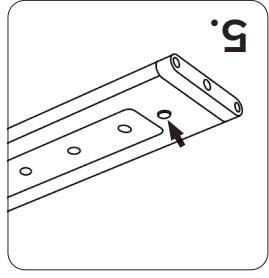

SL12-66: Mounting Clips for use with HMS single arm mounting systems.

SL12-66: HMS Mounting Assembly sold separately.

## Button Modes

**Unprogrammed** (Blade has not been connected and programmed with myAI or Mobius)

Action	Coral Grow	Coral Glow	Refugium	Freshwater
Single Press (Cycles through intensities)	(All Channels) 1%, 20%, 40%, 60%, 80%, 100%, 0% (Blue and Royal Blue Only) 1%, 20%, 40%, 60%, 80%, 100%, 0%	1%, 20%, 40%, 60%, 80%, 100%, 0%	1%, 20%, 40%, 60%, 80%, 100%, 0%	1%, 20%, 40%, 60%, 80%, 100%, 0%
Press and Hold while applying power	Factory Reset	Factory Reset	Factory Reset	Factory Reset

**Programmed** (Blade has been connected and programmed with myAI or Mobius)

Once a Blade fixture is programmed - pushing the button will act as a 2hr override unless the Exit Override is triggered.

When the Override period ends the program will resume at the current time.

Action	Coral Grow	Coral Glow	Refugium	Freshwater
Single Press	50% intensity, 2hr duration	50% intensity, 2hr duration	50% intensity, 2hr duration	50% intensity, 2hr duration
Press, Press	100% intensity, 2hr duration	100% intensity, 2hr duration	100% intensity, 2hr duration	100% intensity, 2hr duration
Press, Press, Press	Exit Override	Exit Override	Exit Override	Exit Override
Press and Hold	0% intensity, 2hr duration	0% intensity, 2hr duration	0% intensity, 2hr duration	0% intensity, 2hr duration

# Blade® Quick Start Guide



